



Project: **GRANT HIGH SCHOOL MODERNIZATION**

Date: May 10, 2018

Time: 6:00p-8:00p

Purpose: DAG Meeting #11

ATTENDEES

<i>Name</i>	<i>Company</i>	<i>Telephone</i>	<i>Email</i>
-------------	----------------	------------------	--------------

SEE ATTACHED ATTENDEE LIST

AGENDA

- I. Opening 6:00-6:25
 - a. Purpose of the Meeting 6:00-6:05
 - b. Meeting Format, Opportunities for Engagement 6:05-6:10
 - c. Introductions 6:10-6:15
 - d. Project Status Overview 6:15-6:25

- II. Overview and Summary of Options 6:25 – 6:50
 - a. Brian Oylear, PPS Project Team: Program Update, Budget Summary
 - b. Carol Campbell, GHS Administration:
 - c. Marshall Haskins, PPS/GHS Athletics:
 - d. Shawn Rogers, Portland Parks & Rec:

- III. DAG Q&A 6:50 – 7:00

- IV. Community Q&A 7:00 – 7:15

- V. Pro's and Con's Workshop 7:15 – 7:50
 - a. 4 Stations open for public input
 - i. Station 1: Leave fields in existing condition.
 - ii. Station 2: New Softball Field located in north field.
 - iii. Station 3: Grant Bowl improvements to include Softball Field
 - iv. Station 4: Other Ideas

- VI. Summary & Close 7:50 – 8:00



MEETING MINUTES

- I. Opening of presentation made.
- II. Overview and summary of the options were completed.
- III. DAG Q&A
 - a. Question taken from the DAG included:
 - i. Why was this the only program element to be removed?
 - ii. Why has there been a delay in updating the DAG on this important revision?
 - b. Dedicated time for the DAG gave way to comments and questions that came in from the community.
- IV. Community Q&A
 - a. Most of the remaining time allotted for the meeting was spent on taking questions and comments from the community. Numerous comments and questions were made. The following is a sample of them that were noted:
 - i. Most comments made were in support of keeping the softball field as per the original master plan in the North Field.
 - ii. Questions regarding Title IX were raised. How Title IX is defined and applies to the softball field will need follow up.
 - iii. We have an opportunity to make it right and provide the softball team with a good facility.
 - iv. What opportunities are out there for corporate partnerships? How can the community help rally financial support? The community can help but not providing the field is not acceptable.
 - v. What participation is Parks making to receive the benefits of the upgrades made by PPS to their property? As an example Portland Parks & Recreation contributed over \$500K to the Grant Bowl project.
 - vi. Why is the Dog Off Leash Area such a large factor? Just move it.
 - vii. There are many other parks with softball fields that overlap with other uses, why is it such a big deal here?
 - viii. Could improvements to Wilshire Park be an option? In lieu of the North Field, could we look at making Wilshire Park a state of the art softball facility?
 - ix. Improvements to the Grant Bowl are wanted, but not at the expense of a dedicated softball field. The Grant Bowl is not ideal for a softball field.
 - x. Why not have the south field use as softball and relocate the baseball team?
 - xi. Many of the players noted that natural turf is preferred over artificial turf for softball.
 - xii. Softball at Wilshire or other remote location means more time away from the classroom.
- V. Due to the time needed for the extended Q&A session, time was limited to complete the planned workshop. However, the meeting was kept open over the planned period and opportunity to meet with smaller groups was made available. Many comments were collected. Attached are photos of the comments collected.

ATTACHMENTS:

1. Attached is a copy of the presentation made at the meeting.
2. Photos of the Pro's and Con's collected at the stations.



Design Advisory Group Meeting 11 Grant High School Modernization 05.10.18



Tonight's Agenda

- Opening 6:00 – 6:25
- Overview and Summary of Workshop 6:25 – 6:50
- DAG Q&A 6:50 – 7:00
- Community Q&A 7:00 – 7:15
- Pro's and Con's Open Workshop 7:15 – 7:50
- Summary & Close 7:50 -8:00

Design Process Recap :: Public Involvement

Factors Influencing Design

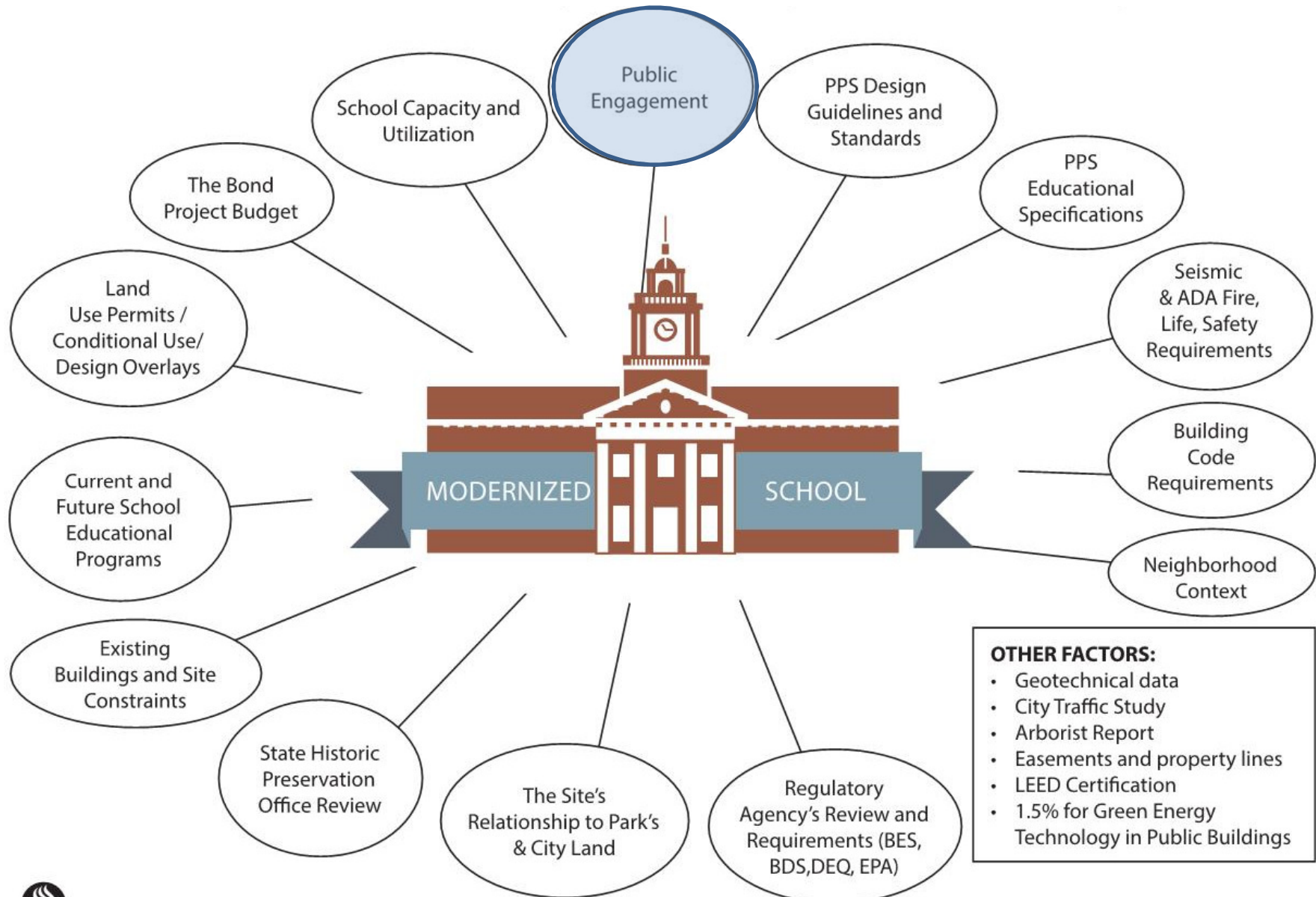

Design Advisory Group (DAG)



PM 6:49 APR/28/2016



DAG Project Goal

*“The Grant High School modernization will result in an **inclusive learning environment** that fosters strong, productive **relationships** among students, teachers, and the community through **inspiring, flexible spaces** that **honor the history** while supporting **students’ success** in college, career, and life.”*



Teacher/DAG/Community Input to Date

10 DAG Meetings

6 Community Workshops/Open House (average 100+ attended)

+ 100 Teacher/Admin & All Staff Meetings

+ Countless Student Engagement Events

+ PTA & Board Meetings

+ School Tours

+ On-Site Construction Tours

For Discussion Tonight :: Athletic Field Options

Existing plans do not include build out of the Softball Field

Option 1: Existing plans remain to not build out new softball field

Option 2: Softball field located in the North Field area.

Option 3: Upgrade Grant Bowl

Option 4: Other Ideas?

Shared Property

- Use of the Athletic Fields are shared in ownership and use between PPS and PP&R

Site Development

Mayer/Reed mahlum

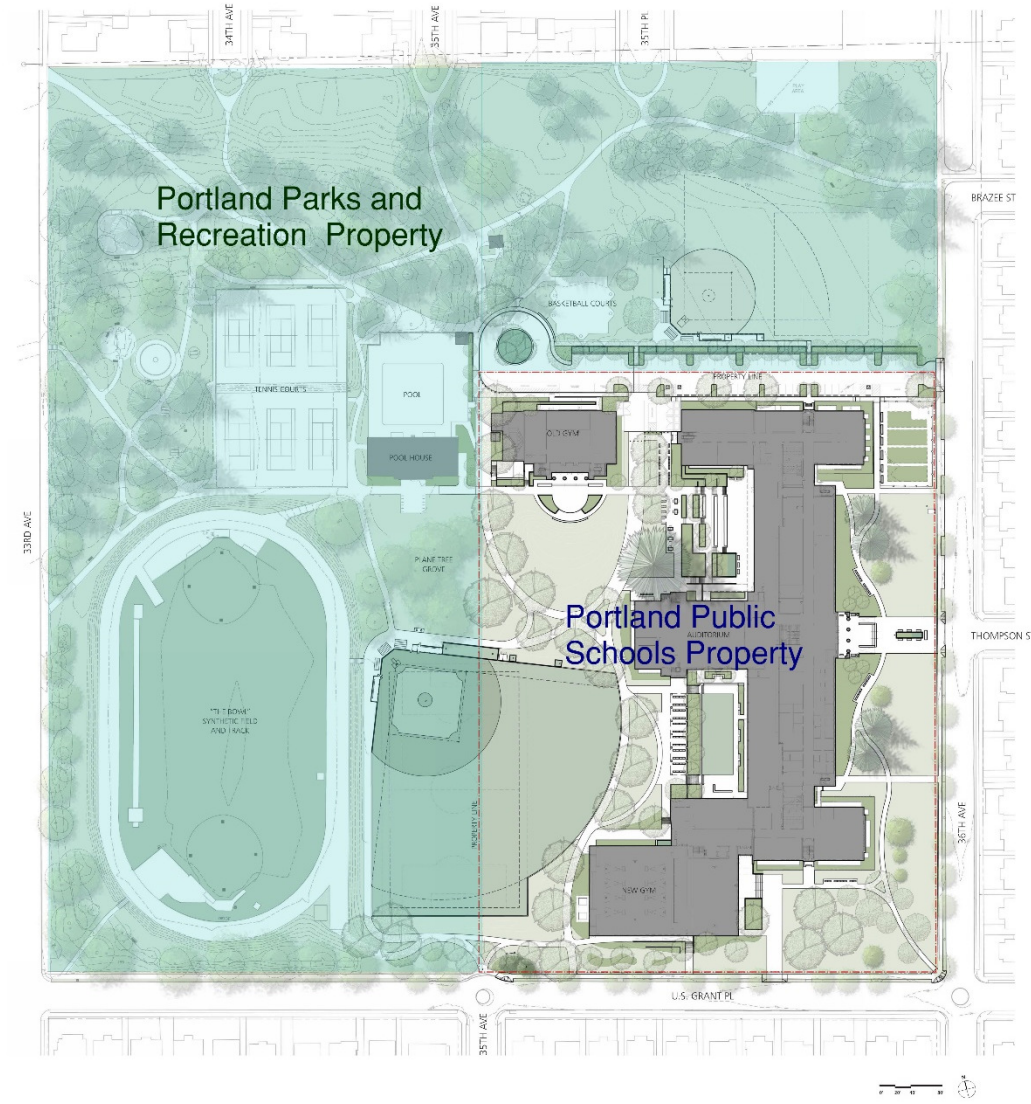

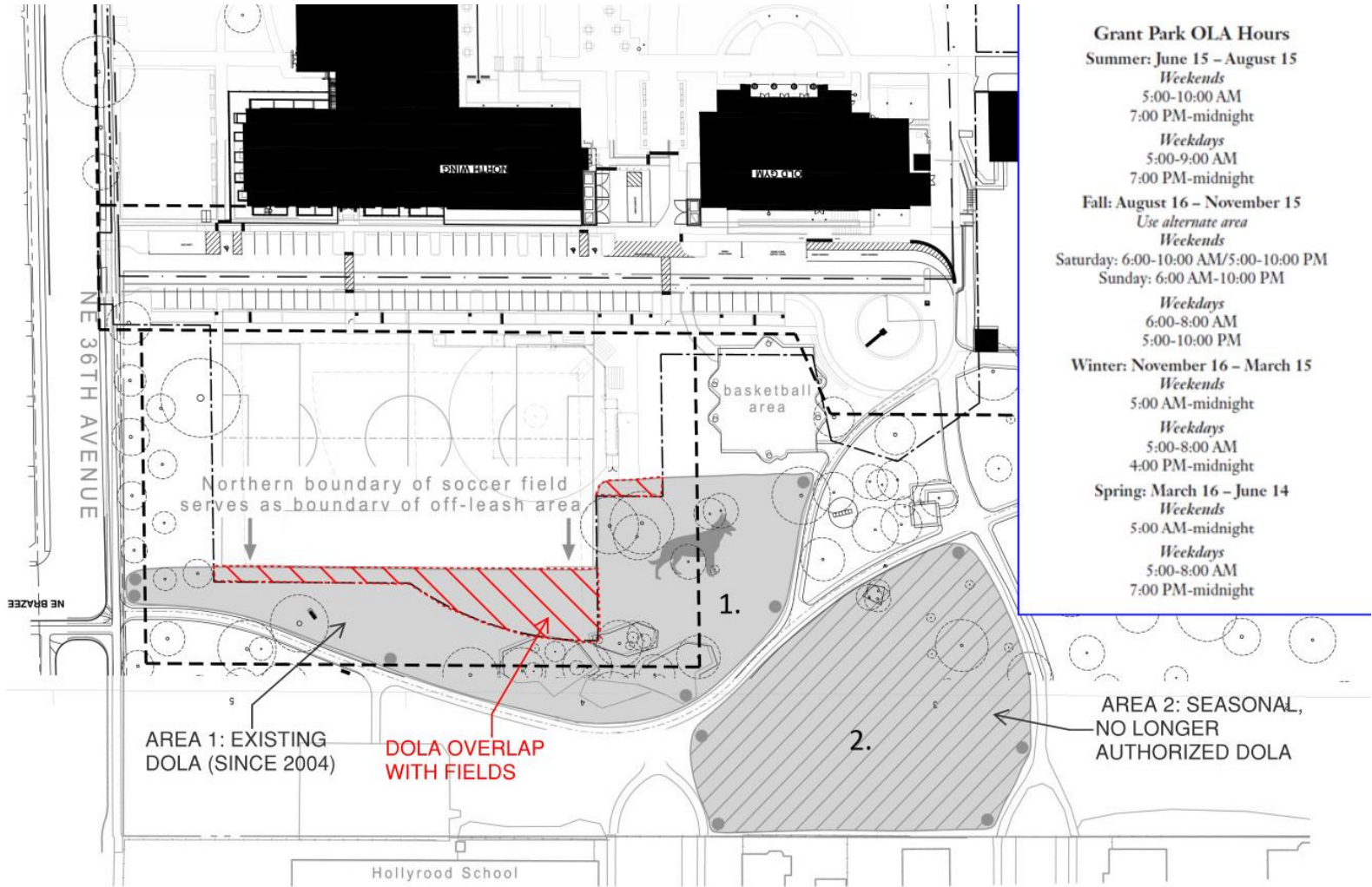

North Field

Option 1

Current Design
Remains As-is

- Softball team continues to use Grant Bowl for practice when available, and
- Softball team continues to use Wilshire Park for practice and games

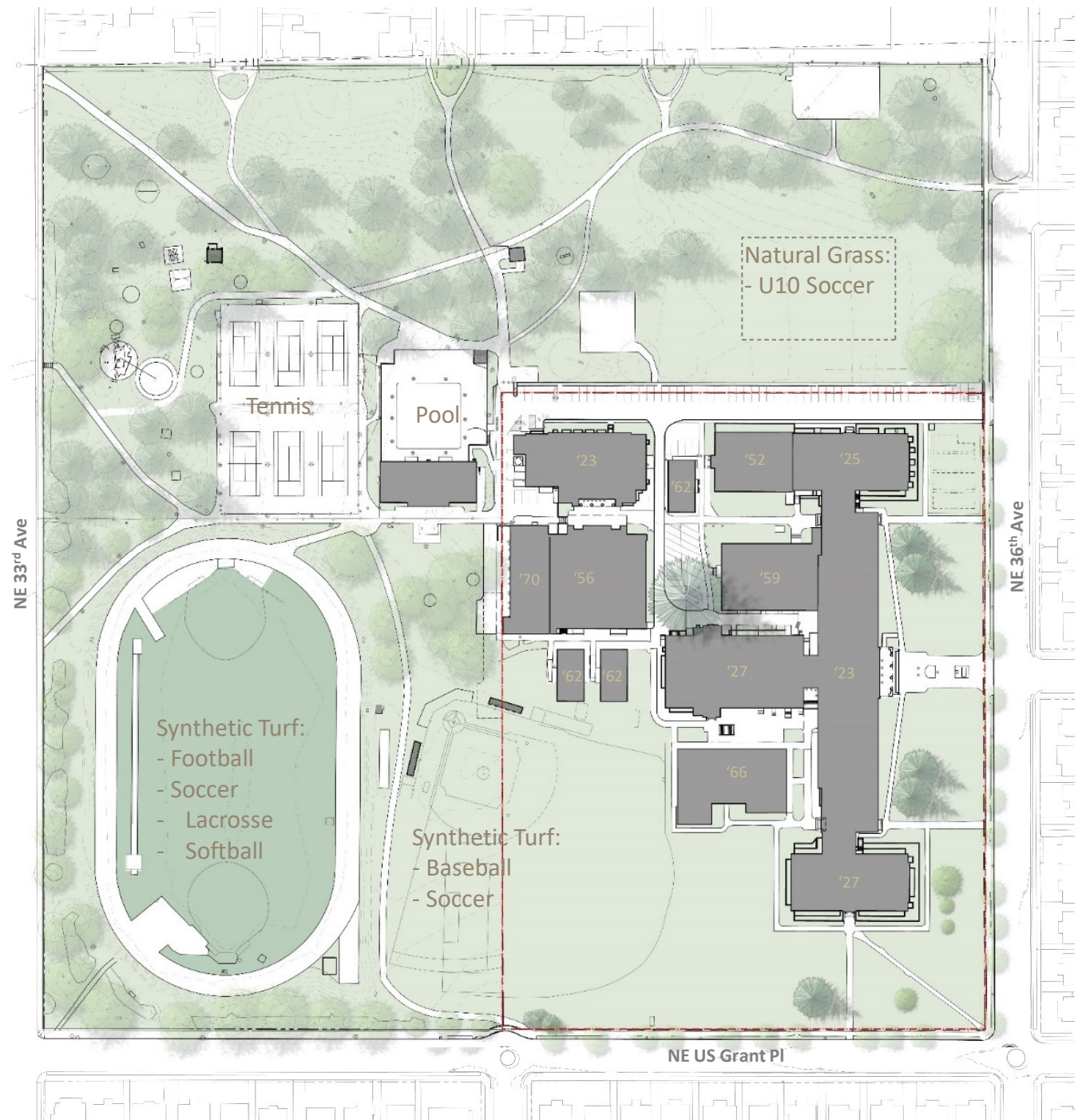

Option 2

Softball Field @ North Field

- Softball uses North Field for practice and games
- Continued use of Grant Bowl for practice when available
- Use of Wilshire Park will be affected due to scheduling of Park activities
- Additional requirements from original scope including safety netting, drinking fountain, ADA upgrades
- Land Use Approval is complete. Building Permit is needed.

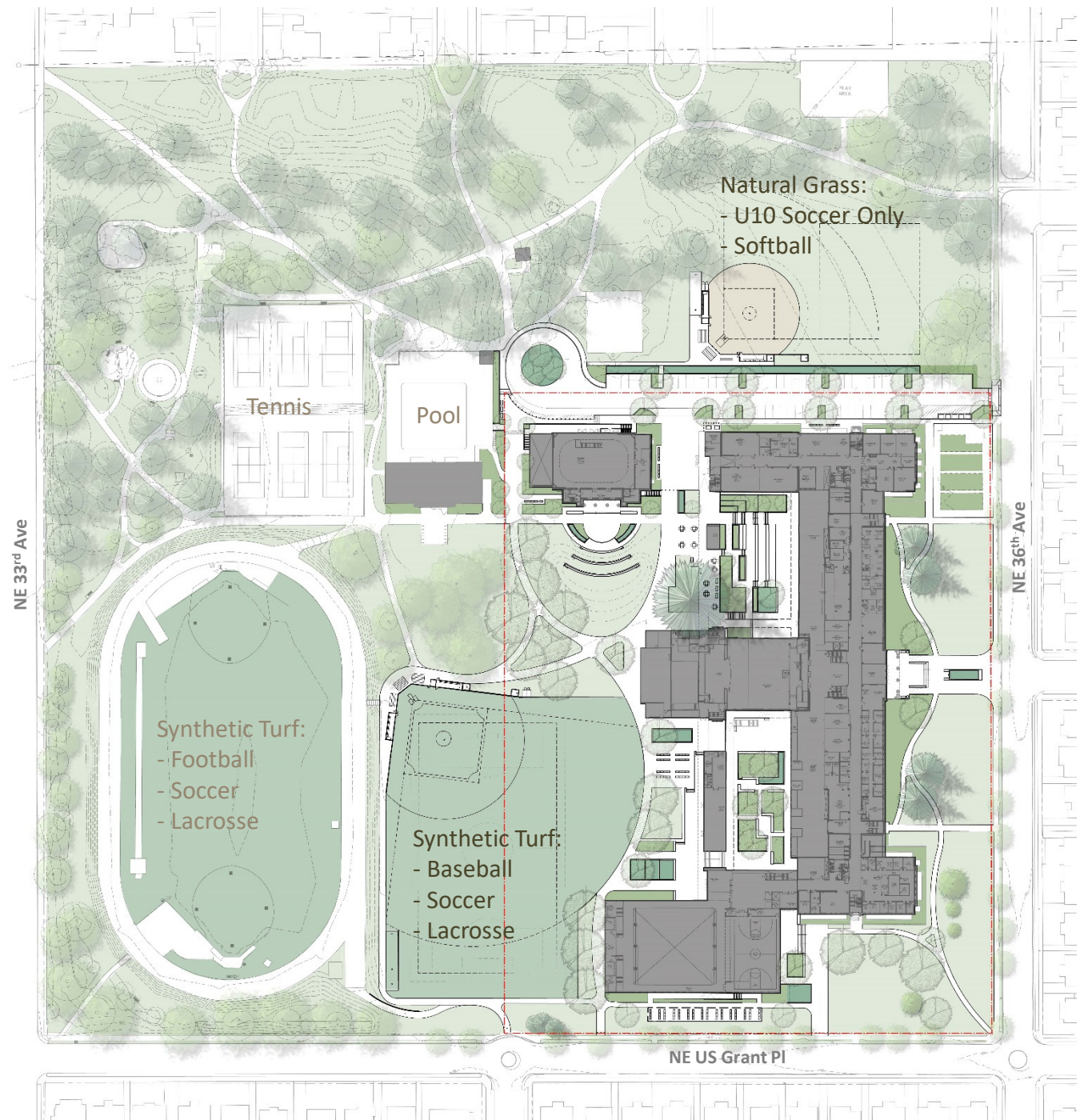

Option 3

Grant Bowl Upgrades

- Grant Bowl is utilized for practice and games during evening hours and inclement weather
- Use of Wilshire Park remains an option
- Scope to include lighting, bleachers, crowd control fencing, concessions, restrooms
- Project will need to be set up to include Master Planning, Fundraising Land Use Approval, and permitting

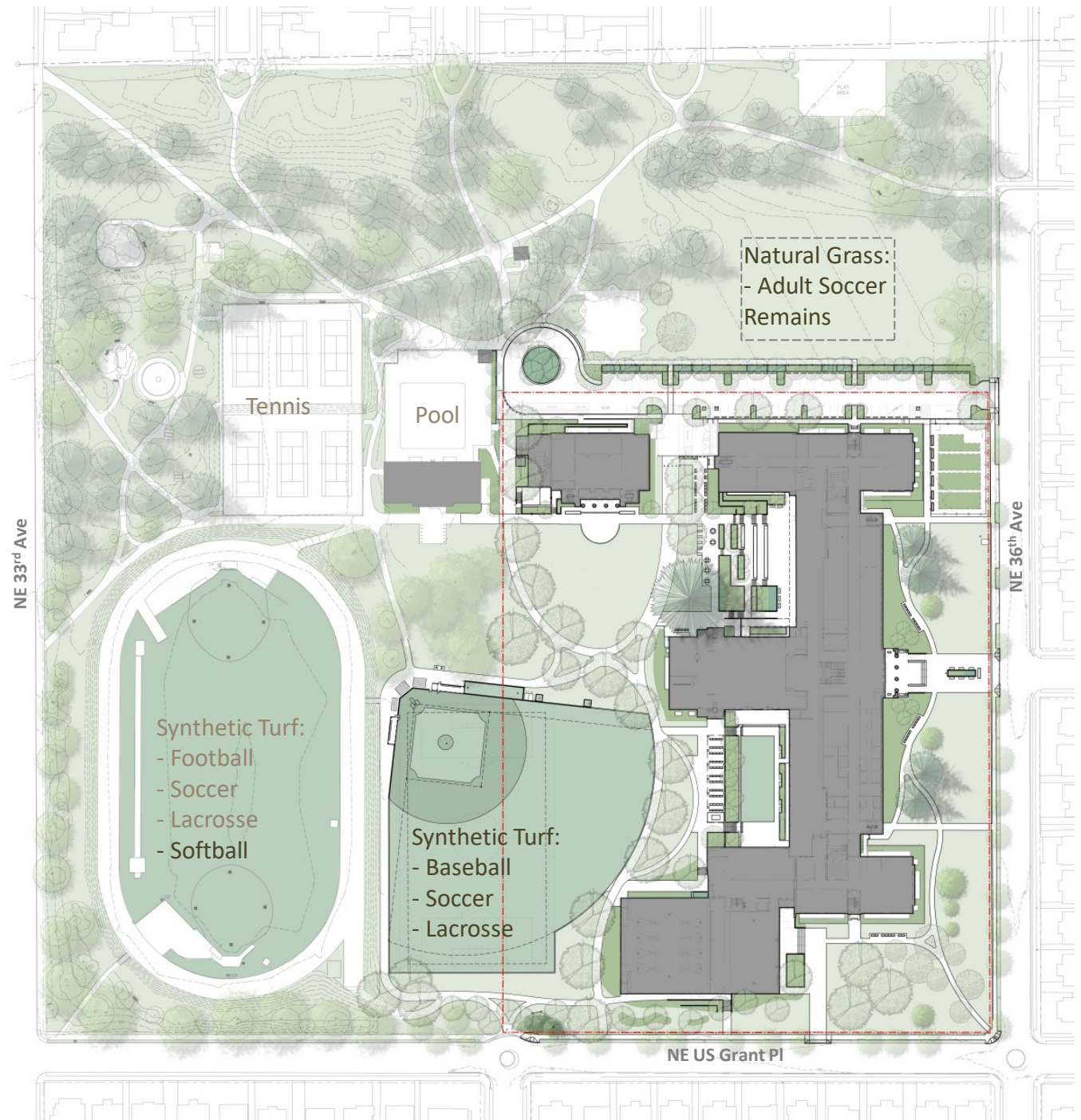

OPTION

PRO'S

the trees are safe

no dogs

(That was sarcasm if you couldn't tell)

how dare we hurt trees, it's not like we can re-plant them or anything it's not like we've ever destroyed trees before for PPS construction

Is it possible to move the off leash dog area to the east side of the campus, away from all athletic fields

None

CON'S

unsafe
too many people at track
no permanent fence
kids miss class

TITLE 9

out of play balls
no clear distinction between in field/out field

"WHEN AVAILABLE"

no lights

POTENTIAL OTHER LAWSUITS

WE WANT DIRT

Taking time out of my education to leave early to use facilities that are far because we don't have access to a field on campus

Softball not in same area
Softball games in bowl would be unsafe

Bowl too dangerous for softball

Other sports on same field

Baseball was automatically put on the plan & it wasn't adjusted

There's so many teams it's too crowded Not gonna work

Option: Sucks

Too much we - H.S. T&F, Ms. T&F, Lacrosse, soccer, etc

TITLE 9

TITLE 9 VIOLATION

Summer - Softball

have to continue to find rides there

Doesn't seem like anyone is going to plant trees on the field or build a fence in any way

Make the pros side bigger and the cons side nonexistent

OPTION 2

We start with this field

very little risk of any balls hitting anyone's head and 700 far away

Cons aren't parked there when games cancel are played so no one in the way

We can walk out of school and be at our field!!!

We actually get a field!

~~Cost~~

Smaller Soccer field

Need to ensure it remains a multi sport space

girls finally get their field

Lower profile on North field than on track/in bowl

Can easily get a lot of parking on the track

Equal

NONE

DIRT

The younger kids can have this is GRANT

we get our own field

Pro - Softball field gets a special field. Soccer keeps old or use it for a possible site on baseball field

Need to PR to get to Little league Adult game pitch

athletes all say same thing

-equality
WOMEN'S SP. MATTER.

Softball field is always on the way out of the building

Why should softball have to go to wisdom why not boys

Equal opportunity.

you won't get sued ya'll like c'mon

I get an equal opportunity to the boys

building program

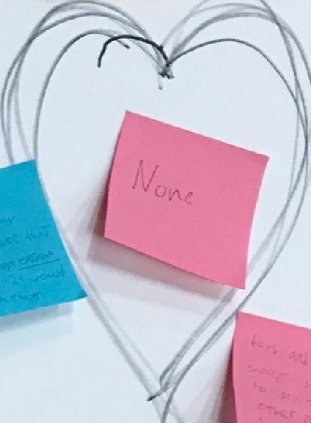

Absolutely nothing!

how did girls want to have their own field to play on

We don't have to leave school 1/1.5 hrs early

More room in bowl if 100m to field

Community can pay \$ to play in nothing

Tony (5th) the cost of softball team can cover all the other costs we have had in the past

No Law Suit!!

was in the remodel don't take it out

PUT UP TOUR BILL SIGNS LIKE EXCEL online bill print class easy

This is

No tree need to be removed

IT WILL ONLY SERVE 25 KIDS !!

NO LIGHTS

Plans already drawn up

We don't want a turf field, we want soft, we weren't meant to play on dirt, and the stadium has to sit in the middle so it's hard to get to when it rains, so if we wanted to have a turf field

lawsuit

higher + stronger sense of community and support

By the way a fence starts the lawn parked right by the field would be good because it's a good sign for the school and it's a good sign for the community

Con - Need to expand program Softball & Soccer area to encompass softball & soccer use

OPTION 3

PRO'S

Will serve/support 6+ programs
500+ students

Lights improve capacity.
ready to blanket
newer safety

MIGHT
Get us
lights and
bleachers!!!
Track
FS
MSK
WSDC
DB
CAX

We might
get snacks!!
but no
field

Lights would allow
flexibility
for field times.
It's not just
softball that should
have lights

Having Lights
means ALL Fall
and spring programs
can successfully
take place to the

Pro -
That the Hollywood
Bowl plays a soccer
ball. Lights
will increase usability
of bowl bowl

CON'S

We don't
get our
field!

It needs to
be set up AND
approved, where
option 2 is already
ready to go

NOT ENOUGH
SPACE
For the football
Track / base
- can't share
same space

What if the improve
lighting is a good idea
but the stadium is not
big enough for all the
activities?

Expense

Can track field
and football people
really share the
same field with
Football?

Not safe
to have so
many sports
going on at
same time!

Con -
Hollywood Bowl
gets no damage or
grind marks. Field
is available in all
winters

All the same
safety conditions
concerns as
option 1

Con - Softball
field not in
optimal or safe place
to play or practice
Hollywood bowl seems
to be owned by dog
owner

The bowl
lights/stadium
is a separate
private facility

IT SERVES THE MOST KIDS!!
IN MULTIPLE SPORTS ACROSS
MENS = WOMENS PROGRAMS!!

I don't understand why the
lights & seating AND the
softball field can't both
happen.

Should turf the Hollywood
field

Use of the bowl is inherently unsafe
for softball, both for players (due to
features of the track, such a long jump pits
that girls run into + trip while dusting flies) +
to spectators from foul balls



Easel Pad
Tableau à feuilles mobiles
Block de Hojas Repeccionables

Super Sticky
Super Collant
Super Adhesivas

1.5 IN (3.8 CM) x 3.5 IN (8.9 CM)
5.5 IN (14 CM) x 11 IN (28 CM)
Color: 1.0000 0000 0000

3M

OTHER IDEAS?

No Grant
Athletics should
get fully funded/
but unless all
teams have a home
ground.

DIS OUT HOLLYWOOD
ALL THE WAY TO THE
PITCH. THIS ALWAYS
CONTAINS SOME OF
THE BEST OF THE CITY

GIVE ME
THE FIELD
I DESERVE!
TITLE 9!

FERN
HILL PARK
FOR
SOFTBALL

Fern hill is
ever further
than Wilshire
just give us our
field

SYNTHETIC
IS NATURAL
IN ORDER
HAVE FUNDS
FOR BOTH
BASEBALL &
SOFTBALL

Community level
softball & soccer
field to be put
at Wilshire field.
No other location
made the way to be
considered as it will
be better for both

option 3 is being used
to distract. The softball field
and lights/seating should
both be done. Lights/seating
at bowl is a separate issue.

IMPROVE
WILSHIRE PITCH
SOFTBALL FIELDS TO
STATE OF THE ART

PPS should have
asked DTA to help
with ideas and
community out-
reach a year ago
when the budget
cuts were first
discussed. I can
see that bill @
Grant provide them
in a short note -
or asking the
community to
lead.